

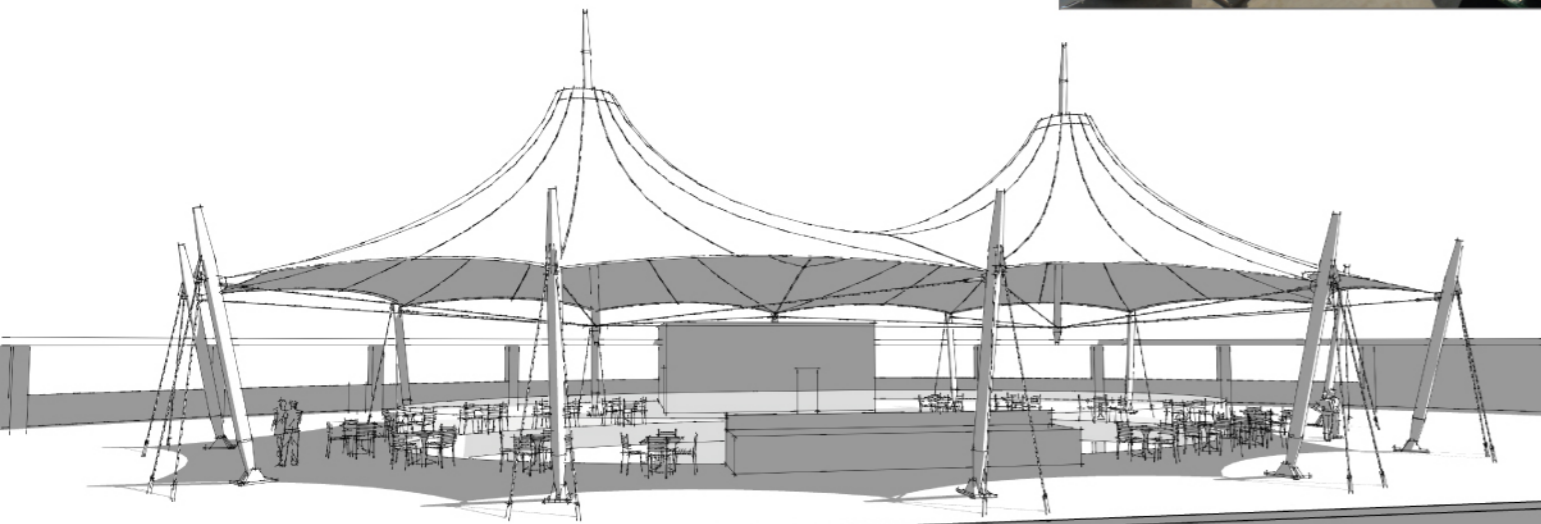

FERRARI
architecture

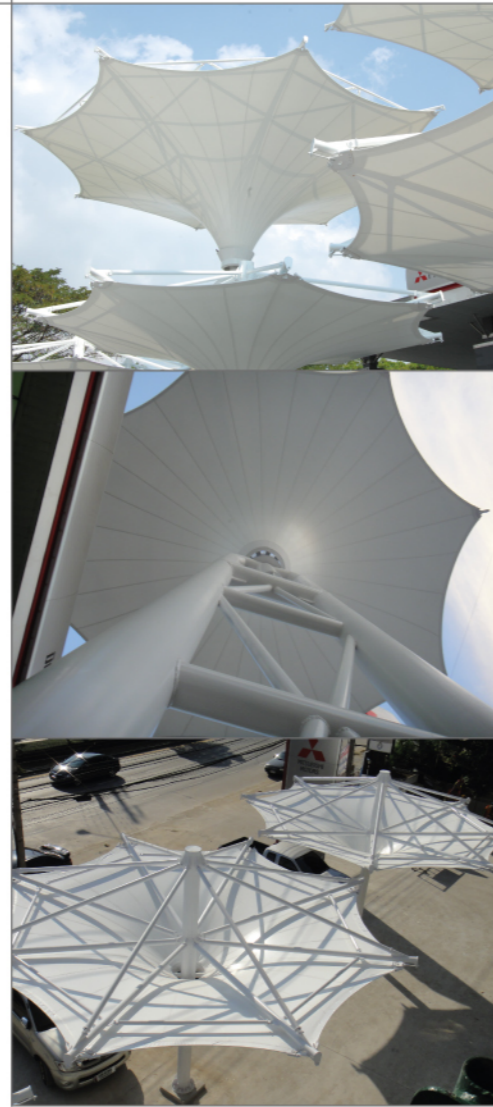

A well known French brand we have selected to create our great design.



Fameline Products Co.,Ltd.
72/17 M. 3 Tepharak rd.
Bangpleeyai Bangplee
Samutprakarn 10540
Tel:+66(0)27553641-5
Fax:+66(0)27553664
info@fameline.com
www.fameline.com



**FREEDOM OF
FREEFORM
ARCHITECTURAL
SUNSHADE**



Printed in Thailand : 2013



TENSION MEMBRANE
FOR ARCHITECTURE



TENSION MEMBRANE DESIGN

A hi-strength architectural tensile fabric which can artistically create a free form shape of designs that can be used as aesthetic as well as functionality form.

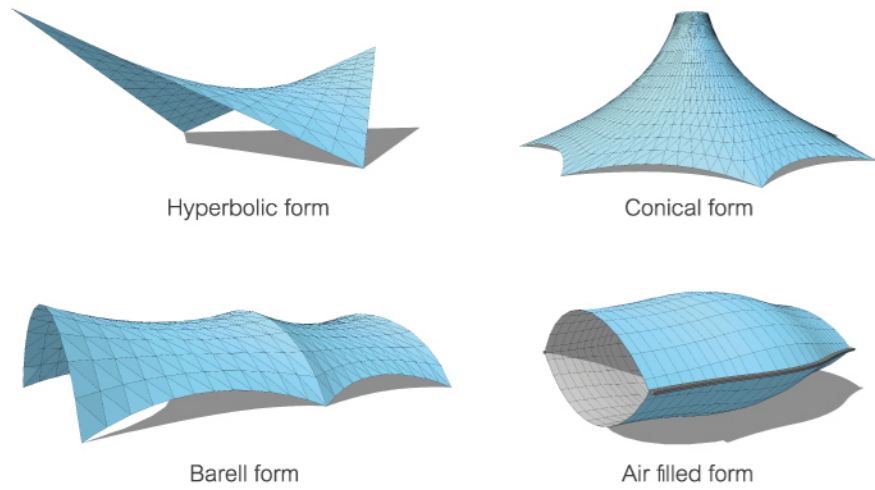

ELEMENTS OF TENSILE FABRIC

Normally, the main core of the tensile fabric is a main textile core which is a polyester bundle, covered by main coating on PVC coating each both side, while on the surface coating will be PVDF coating. Yet, we can provide other specification according to client's requirement.

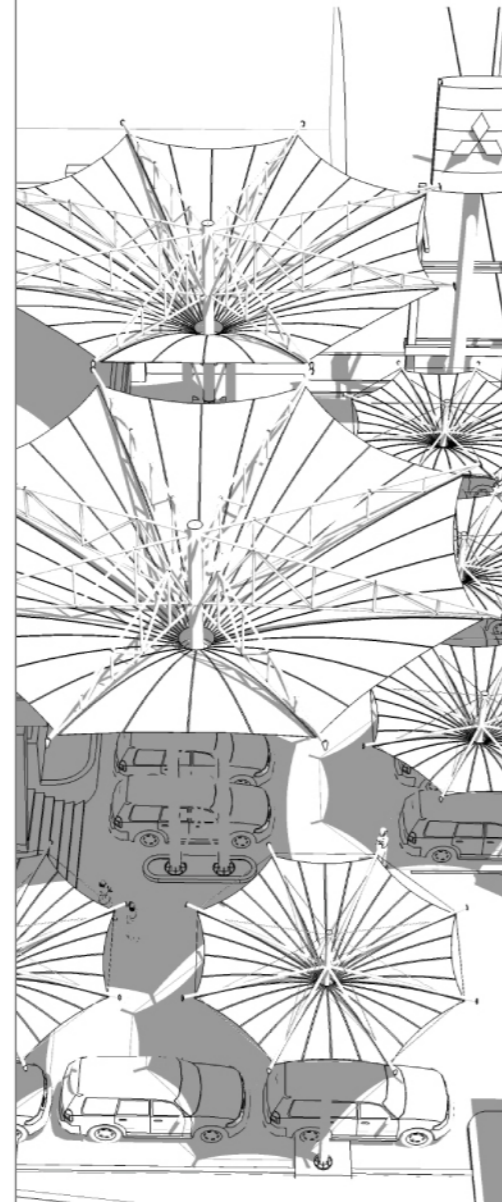
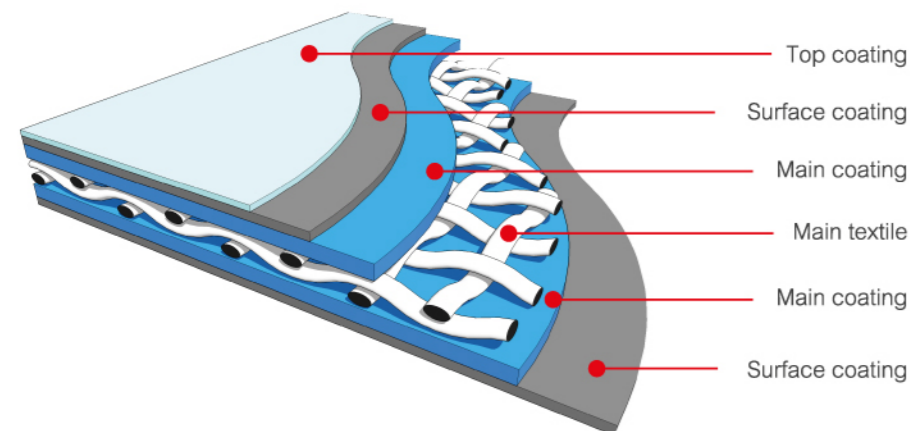

TENSION MEMBRANE WORK METHODOLOGY

DESIGN

The design begins from draft sketches and converted to 3ds model through computer software. We use SketchUp or 3ds Max to complete the shapes and final design which later furnished under Autocad 3d and our proprietary software to provide shop drawings for production of steel structures and fabric patterns.

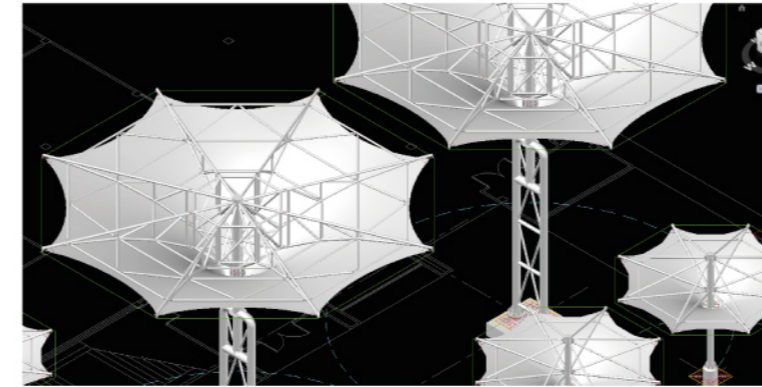

MANUFACTURE

Our manufacturing procures only the best quality materials of structural steels, accessories and fabrics as per the design requirement approved by the client. During the process of steel fabrication, we do the pre-test installation of each structure in order to confirm the perfection before packing and sending to site for final installation.



INSTALLATION

The installation begins by providing the details of safest foundation and by direct involvement at the construction site of experienced architect and engineer to ensure all works to match the final approved design and 100 % client's satisfaction.



TENSION MEMBRANE REFERENCE PROJECTS

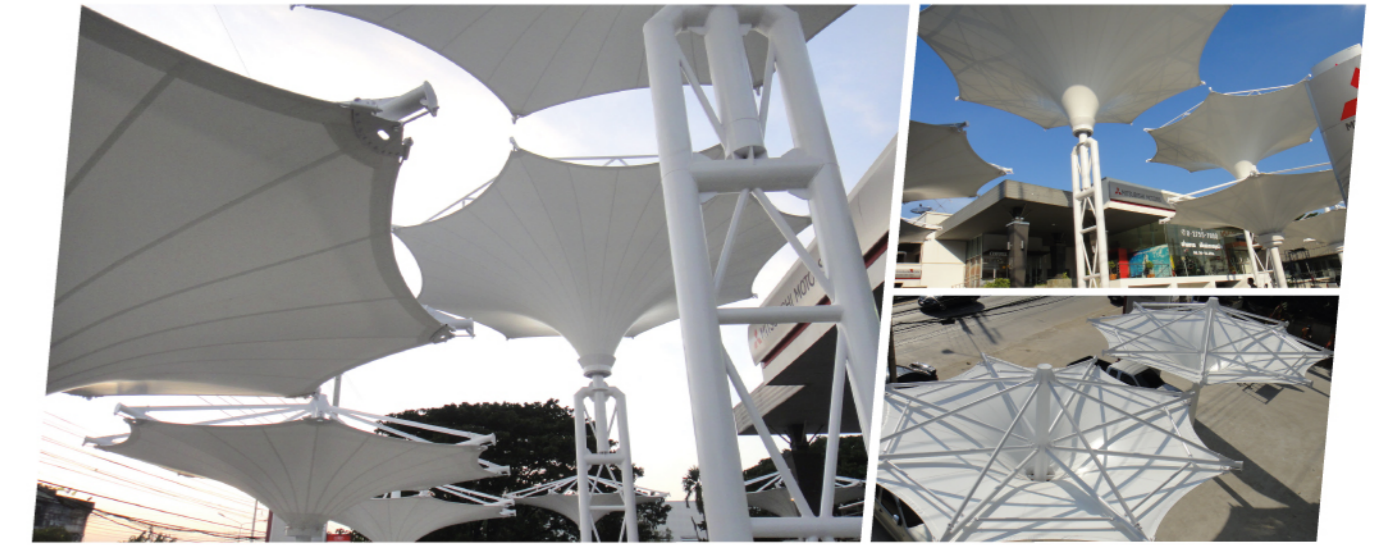

Project : Mitsubishi show room, Samutprakarn, Thailand / Fabric Area : 794 sq.m. / Function : Sunshade canopy



Project : NIIT Technologies, Greater Noida, India / Fabric Area : 3927 sq.m. / Function : Sunshade canopy



Project : Charoensri Night Plaza, Udonthani, Thailand / Fabric Area : 3480 sq.m. / Function : Green Architecture Outlet Mall